



Next Level Starts Now:

Introducing the New Platform
for Supply Chain Agility

Now there's a new turnkey partner that takes custom work platforms from concept to installation faster and more accurately than ever before. NexCaliber Structures™ delivers large-scale automated solutions required by today's agile supply chains with elevated performance, ease and scalability.



NEXCALIBER
STRUCTURES
by STEEL KING INDUSTRIES



**NexCaliber Structures™
by Steel King**

What if

You could accelerate your next engineered work platform project while minimizing risk?

(You can – with turnkey solutions from NexCaliber Structures)

If you are an owner or integrator in the fast-growing 3PL, ecommerce, logistics or distribution industries, you are experiencing unprecedented challenge and market demand.

Keep pace with NexCaliber Structures, an integrated new design/build resource that helps you meet the needs of today's high-volume, complex automated facilities.

NexCaliber Structures combines the innovative spirit of a market-driven professional services company backed by the stability and strength of Steel King Industries, a leading material handling manufacturer with more than half a century of expertise.

Structure Your Success with a Whole New Delivery Platform:

With the NexCaliber approach, you'll gain the advantage of a lean, collaborative track to explore platform solutions, maximize value, and take cost and waste out of the process.

Visualize

Your Custom Solution with Smart 3D Design Technology

Use our 3D design visualization software technologies to quickly determine the most successful solution for your operation. It's never been easier to configure (and reconfigure) custom platforms and accessories, review costs, and determine the most successful and efficient alternatives for your footprint and workflow.

Fast-Track

Concept and Estimating with PET

Expect rapid, accurate quotes and simplified 3D models with our automated parametric estimating technology (PET). Assemblies and components are instantly populated from CAD models, giving you detailed oversight into your investment. It's also easier to communicate and track design revisions eliminating costly errors.



Deliver System Value and Streamline Approvals with In-House Structural and Professional Engineering

Breeze through permitting and other approvals with value-engineered solutions that meet AISI, ASTM and AISC specifications, including applicable building codes and OSHA requirements. Professional engineered seals and stamping are provided for all continental U.S. states and Southern Canadian provinces.



Meet Compressed Deadlines and Eliminate Surprises with Critical Path Scheduling

Our fast-track project management system incorporates Critical Path Scheduling (CPS) and weekly project meetings to communicate and manage key deliverable dates, monitor costs and eliminate surprises.



Minimize Risk and Delays with Best-in-Class U.S. Manufacturing

Get the confidence of market-leading platform quality, structural integrity, and industry expertise and reputation with U.S.-manufactured structures by Steel King Industries®.



Meet the
"Go" Date
Efficiently,
Accurately
and Easily

The Next Generation of Efficient, Automated, Elevated Work Platform Systems

NexCaliber's single or multi-level freestanding work platforms are robust custom systems that can accommodate heavy-duty equipment, such as induction conveyors, singulator systems, high-speed scales and shuttles.

Platforms can also be designed as multi-level systems, with all the necessary components— staircases, stair towers, ladders, railing, gates and crossover store systems.

We know the key to a successful project begins with commitment. You can count on NexCaliber Structures to execute a fully-operational platform on-time and on-budget. Just ask about our EOS performance guarantee.

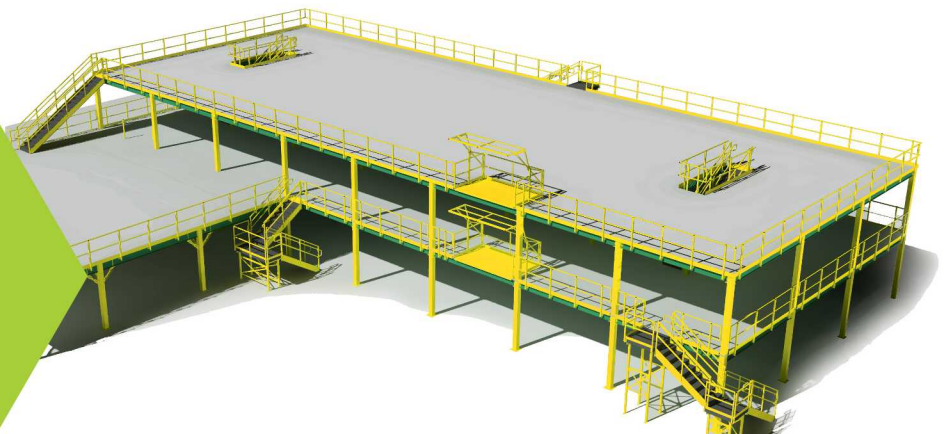

Streamline

Installation and Integration

Count on fast, safe installation and integration into your facility. NexCaliber platform systems are designed for fast, efficient, labor-saving delivery, assembly and startup. Our experienced installation teams will minimize site disruption and meet critical safety standards.



NEXCALIBER™
STRUCTURES
by STEEL KING INDUSTRIES

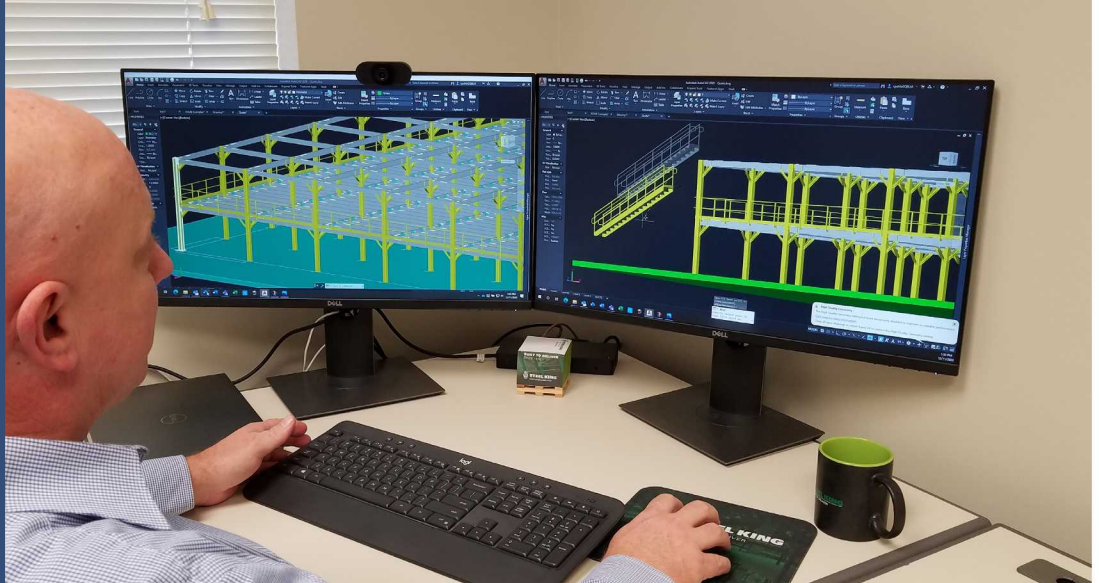

Single-Source Design
Visualization

Value-Engineering

Professional
Engineering &
Permitting

Fast-Track Estimating
& Project Management

Manufacturing

Installation

Elevate Your Expectations

NexCaliber Structures is an innovative new business unit of Steel King Industries, a leading U.S. manufacturer of material handling products and systems. NexCaliber embodies Steel King's commitment to single-source solutions that help manage complexity, shorten lead times and deliver efficiency.

Focused solely on custom elevated work platforms, NexCaliber Structures solves the industry's most complex storage, equipment support and throughput challenges.

Located in Cincinnati, OH, the NexCaliber team is comprised of supply chain professionals with more than 100 years of combined industry expertise in working with integrators, owners and OEMs.

Request an online demo of our virtual modeling capabilities today **513-758-3285** or visit our website at www.nexcaliber.steelking.com.



nexcaliber.steelking.com
Steel King Industries
Attn: Christopher R. Pahls
6507 Harrison Ave • Unit A
Cincinnati, OH 45247-2815